

Junction box XD-JB85 with terminal strip

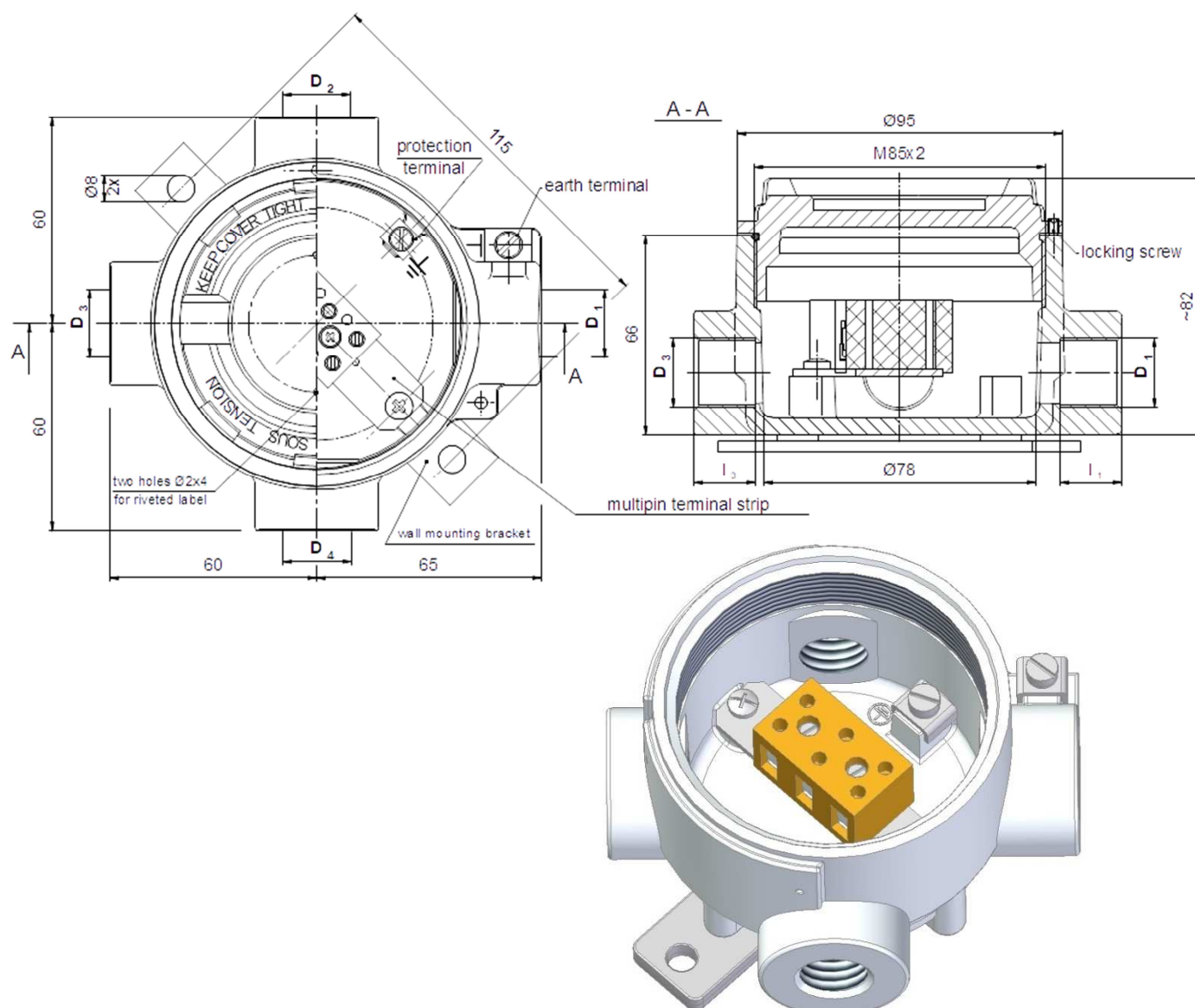

Material of body and cover: aluminium pressure die-casting

Servis temperature: $T_{serv} = -40 \div 100^{\circ}\text{C}$ (85°C with window) – oil-proof TPE rubber

$T_{serv} = -40 \div 150^{\circ}\text{C}$ (85°C with window) – silicone VMQ rubber

$T_{serv} = -20 \div 200^{\circ}\text{C}$ (85°C with window) – FKM rubber

Coating: chromating and chemically resistant paint (outside only)

THREAD D_4	l_4 [mm]	THREAD D_3	l_3 [mm]	THREAD D_2	l_2 [mm]	THREAD D_1	l_1 [mm]	SEAL MATERIAL	COATING
M20x1.5 M24x1.5 M25x1.5 M27x2	20	M20x1.5 M24x1.5 M25x1.5 M27x2	20	M20x1.5 M24x1.5 M25x1.5 M27x2	20	M20x1.5 M24x1.5 M25x1.5 M27x2	20	3	SE
1/2 NPTmod 3/4 NPTmod	16,2	1/2 NPTmod 3/4 NPTmod	16,2	1/2 NPTmod 3/4 NPTmod	16,2	1/2 NPTmod 3/4 NPTmod	16,2	4	Cal
CD		CD		CD		CD		5	SPU
PD		PD		PD		PD			PPU
									P

PROTECTION CONCEPT

Protection Method	Type of protection	Permitted use	Certificate No.	Protection Principle
Flameproof EN 60079-0 EN 60079-1 EN 60079-31	CE 1026 II 2G Ex db IIC T6...T4 Gb 1026 II 2D Ex tb IIIC T=77/97/117°C Db	Zone 1 Zone 2 Zone 21 Zone 22	FTZU 05 ATEX 0329X	Contain the explosion and quench the flame



ORDERING

XD-JB85 - . - .. / .. - .. / .. - .. / .. - .. / .. - . . . + . .

Type of Box

Certified **FTZU 05 ATEX 0262U**

Symbol of seals material

3 = TPE rubber
4 = VMQ rubber
5 = FKM rubber

Symbol of tread $D_4 - D_3 - D_2 - D_1$

M2 = M20x1,5 N2 = ½ NPTmod – modified +1/2 to+1 thread deeper
M24 = M24x1.5 N3 = ¾ NPTmod – modified +1/2 to+1 thread deeper
M25 = M25x1.5 PD = plugged
M27 = M27x2 CD = closed

Notice:

Type: "size of thread / PD" if thread is plugged eg. **M2/PD**, **N3/PD**, etc.

Type: "CD" if opening is closed eg. **XD-JB85-4-CD-CD-M2....**, etc.

Symbol of paint type

SE – spray epoxy – standard; SPU – spray polyurethane (on se layer); C – creodur; PPU – polyurethane powder; P – polyester powder

Symbol of paint colour:

al = ALU natural color; **yc** = RAL 1007 yellow chromic; **ys** = RAL 1003 yellow signalling;
bs = RAL 5005 blue signalling; **sb** = RAL 5015 sky-blue; **sg** = RAL 7032 silicon grey;
gr = RAL 7035 grey; **ag** = RAL 9002 ashen grey-white; **sh** =RAL 9006 - standard; **gs** = RAL 9007 grey-silver;
cw = RAL 9010 cream-white (for more details see technical information)

UNIT TYPE (n-number of terminals(from 2 to 6))

TSn = Mounting kit + terminal strip type **BKn**

ETSn = Mounting kit + terminal strip type **BKn/E** certified **SIRA 01 ATEX 3247U**

TG5/n = Mounting kit + terminal strips type **G5/n**

ETG5/n = Mounting kit + terminal strips type **G5n** certified **Ex e**

Standard products:

XD-JB85-4-D₄-D₃-D₂-D₁-SEsh-TS6

Sample:

XD-JB85-4-M2/PD-M2-M2/PD-M25-SEsh-TS6

XD-JB85-4-CD-N3-CD-N3-SEsh-ETS6

PROTECTION DEGREE

IP	D ₄ , D ₃ , D ₂ , D ₁
54	threaded connection without additional sealing
68	threaded connection with additional sealing

**TSn with
multipin terminal strip BKn**

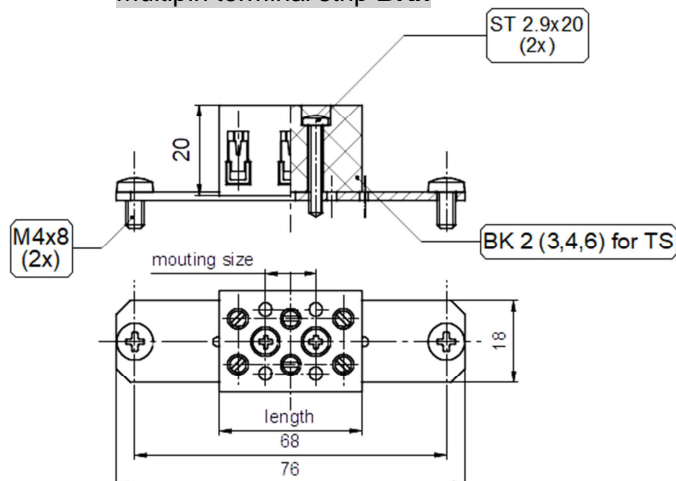

**ETSn unit with Ex e
multipin terminal strip BKn/E**

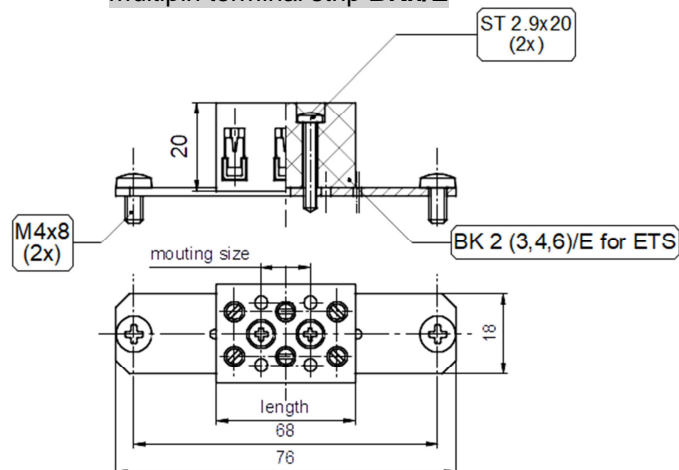



TECHNICAL DATA

TECHNICAL DATA				
Rating data	EN 60079-7	IEC	CSA	UL
Rated voltage [V]	275	400	300	300
Rated current [A]	21	32	10	10
Rated cross-section [mm ²]	4.0	4.0	22 ...2 AWG	
Rated surge voltage/polution severity [kV/-]	6 / 3			
Plug gauge acc. to IEC 60-947-1 / flammability class UL 94	A3 / 5VA			
Approval for ETS	SIRA 01 ATEX 3247U			
Clamping conductor H05V/H07V				
Solid / stranded [mm ²]	0.5 ... 4 / 1.5 ... 4			
Flexible / flexible with wire end ferrules [mm ²]	0.5 ... 4 / 0.5 ... 4			
Tightening torque range [Nm]	0.5 ... 0.7			
Stripping length / clamping screw / blade size[mm]	8mm / M3 / 4.0x0.8mm			
Version	2 - pole	3 - pole	4 – pole	6 – pole
Type TS	TS 2	TS 3	TS 4	TS 6
Type ETS	ETS2	ETS 3	ETS 4	ETS 6
Length / mounting size [mm]	20 / -	31 / 11	38 / 18	52 / 32

TG5/n Unit with Multipin Strips

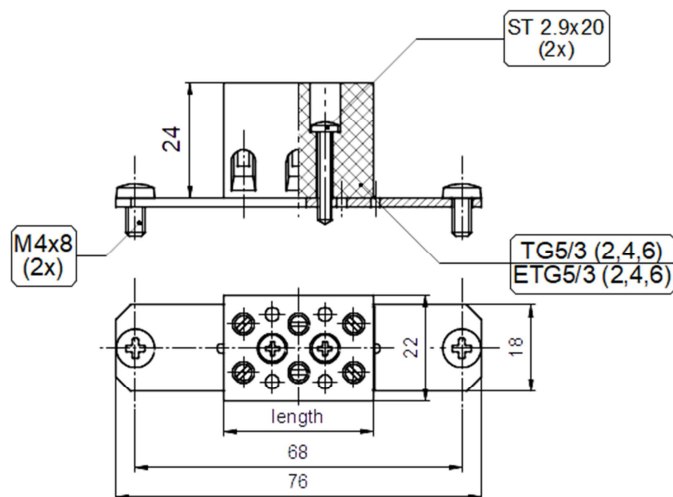

TECHNICAL DATA

Nominal current [A]	32
Nominal voltage [V]	500
AWG	12 - 24
Rated current / cross section [A]/[mm ²]	32 / 4
Rated surge voltage / polution saverity [kV]/[-]	6/3
Surge category / Insulating material group [-/-]	III/I
Rated surge voltage/polution severity [kV/-]	6/3
Conductor cross section flexible, with ferrule without plastic selve [mm ²]	0,25 - 4 / 0,25 - 2,5
2 conductors with same cross section, solid / flexible [mm ²]	0,2 - 1,5 / 0,2 - 1,5
2 conductors with same cross section,flexible, ferrules without plastic sleeve [mm ²]	0,25 - 1,5
2 conductors with same cross section,flexible,TWIN ferrules with plastic sleeve [mm ²]	0,5 - 1
Stripping length [mm]	8
Internal cyrindrical gage / Scraw thread [-/-]	A3 / M3
Tightening torque [Nm]	0,6 - 0,8
Insulating material / Inflammability class acc. to UL 94	PA / VA

Ex e version of ETG5/N unit with multipin strip

TECHNICAL DATA

Conection in acc. with standard	UL / CUL	CSA
Nominal current [A]	300	
Nominal voltage [V]	300	
AWG	10 - 28	10 - 26